

HTS Floor - Product Identification

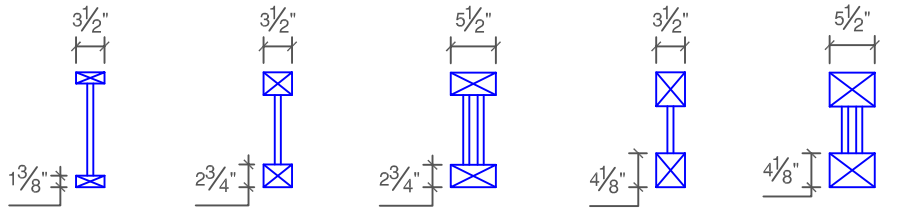

HTS24

HTS34

HTS36DW

HTS44

HTS46DW

Series	Flange	Webs	Available Depths (mm)
HTS24	2x4 MSR 2400 D. Fir	Single	8.75", 10.75", 12.75", 14.75", 16.75"
HTS34	3x4 MSR 2100 SPF	Single	11.25", 13.25", 15.25", 17.25", 19.25"
HTS36DW	3x6 MSR 2100 SPF	Double	17.25", 19.25"
HTS44	4x4 MSR 2100 SPF	Single	16", 18", 20", 22"
HTS46DW	4x6 MSR 2100 SPF	Double	20", 22"

HTS Floor - Connection Details

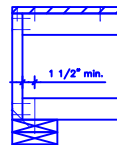
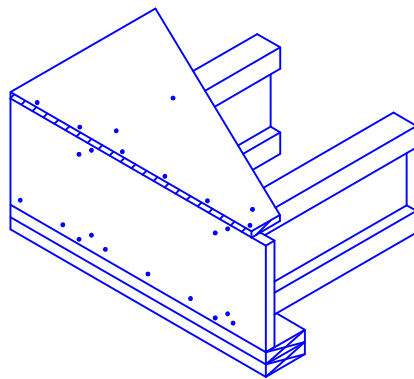

HTS Joist to Rim

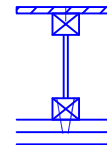

HTS Joist to Bearing

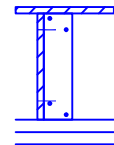

OSB Panel or Rim Board to Squash block

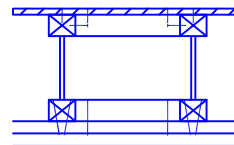

HTS Blocking to Joist

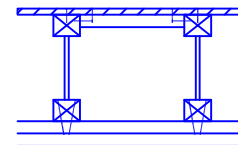

2x4 Blocking to Joist

Subfloor

Glue Subfloor to Rim Board, Subfloor backing, HTS Joists or blocking, and 2x4 blocking with approved sub-floor adhesive.

Attach to Rimboard, Subfloor backing, HTS or 2x4 blocking with 2 1/4" nails or 1 3/4" subfloor screws at 6" o/c.

Attach to HTS Joists with 2 1/4" nails or 1 3/4" subfloor screws at 8" o/c down length of Joist and 6" o/c at splices.

Rim Board

Attach Rim Board to HTS Joists or Blocking with 2 - 2 1/4" nails top & bot

Toe nail to bearing plate with 3 1/4" nails at 6" o/c

HTS Joists or Blocking

Attach HTS24 Series Joist or blocking to bearing plate with 3 1/4" nails

Attach HTS34 or HTS36DW Joists or blocking to bearing plate with SDW22438 screws

Attach HTS44 or HTS46DW Joists or blocking to bearing plate with SDW22600 screws

Keep all screws or nails back from end of joist or blocking a min. or 1 1/2"

HTS or 2x4 Blocking

Toe nail HTS or 2x4 Blocking to top chord or Joist with 2 1/4" nails each side

2x4 Squash Blocks

Attach Rim Board or OSB Panel to squash blocks with 2 1/4" nails top and bottom

Attach Squash Blocks to Joist with 2 - 3 1/4" nails top and bot

HTS Floor - Exterior Wall Details

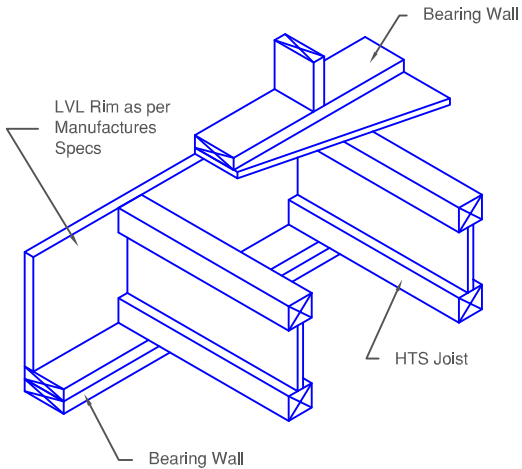

A1 Exterior End Wall

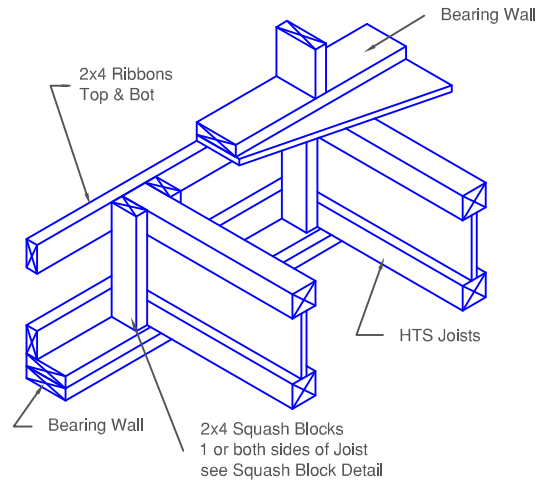

A2 Exterior End Wall

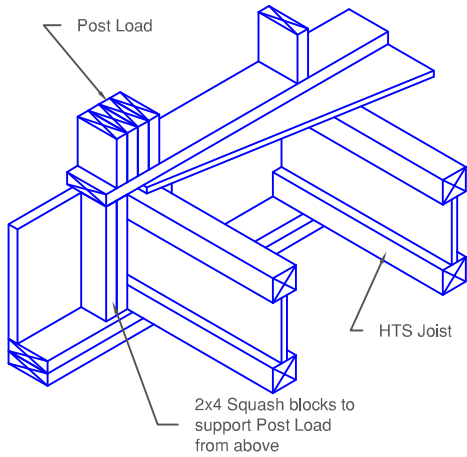

A3 Post Load at Exterior Wall

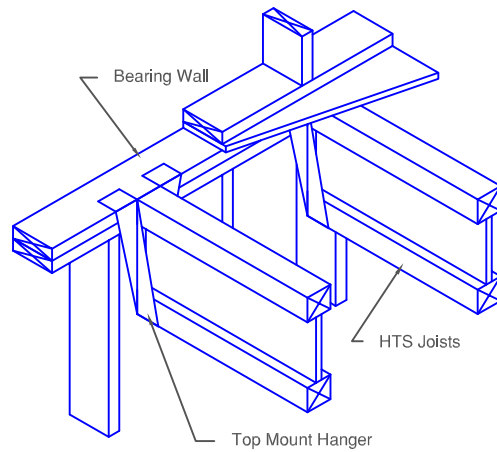

A4 Exterior End Wall

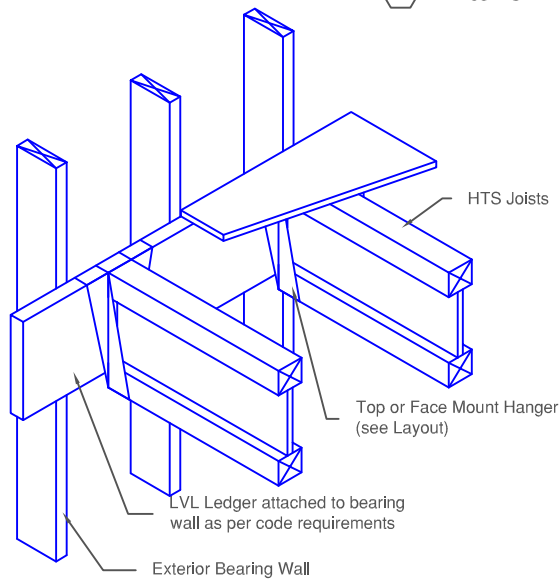

A5 Ballon Framing

HTS Floor - Exterior Wall Details

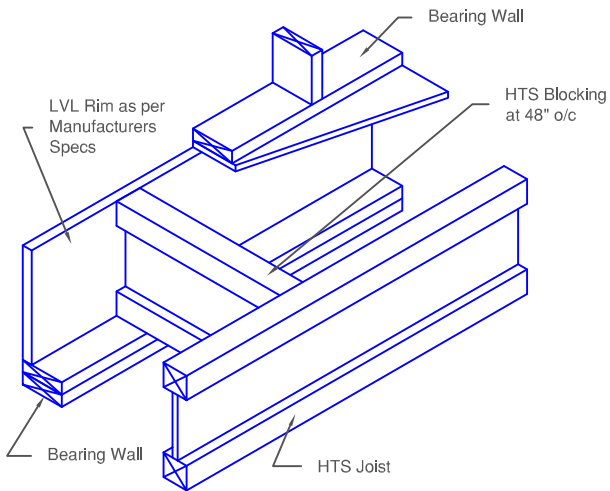

B1 Exterior Side Wall

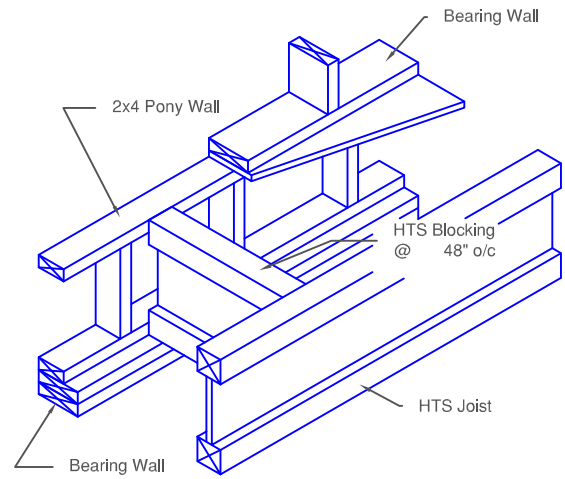

B2 Exterior Side Wall

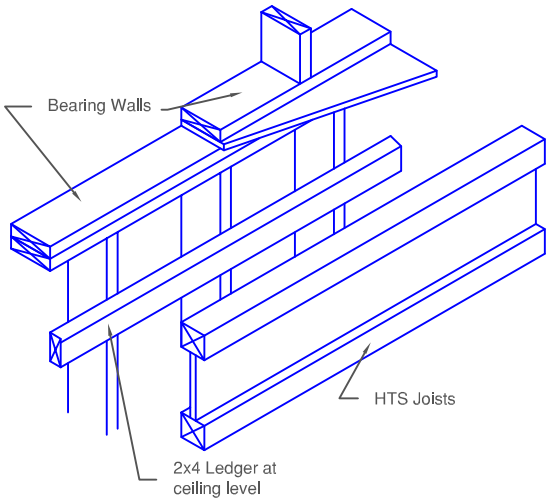

B3 Exterior Side Wall

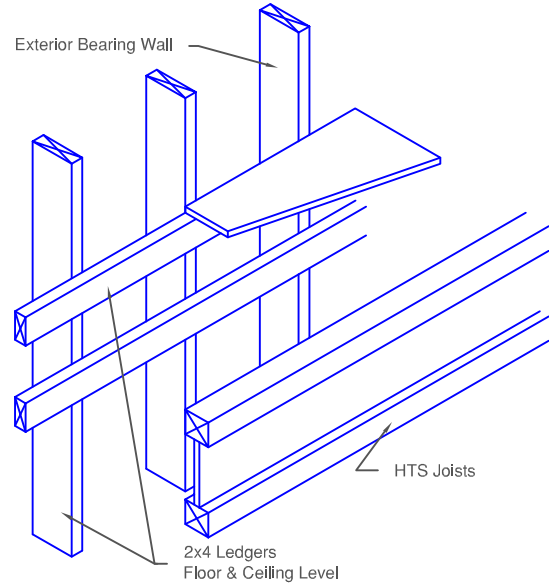

B4 Ballon Framing

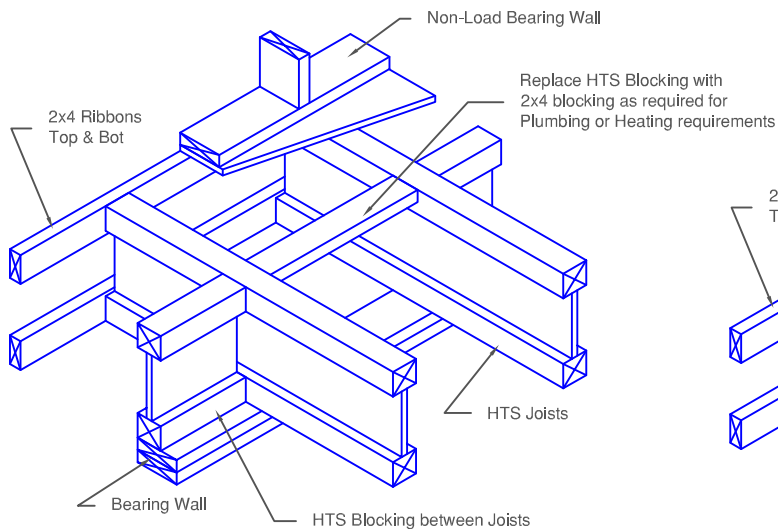

C1 Non-Load Bearing Cantilever

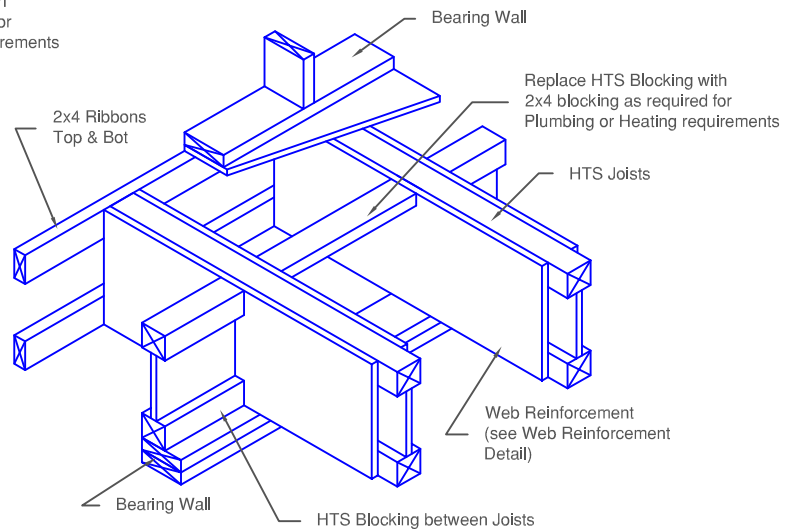

C2 Load Bearing Cantilever

HTS Floor - Intermediate Bearing Details

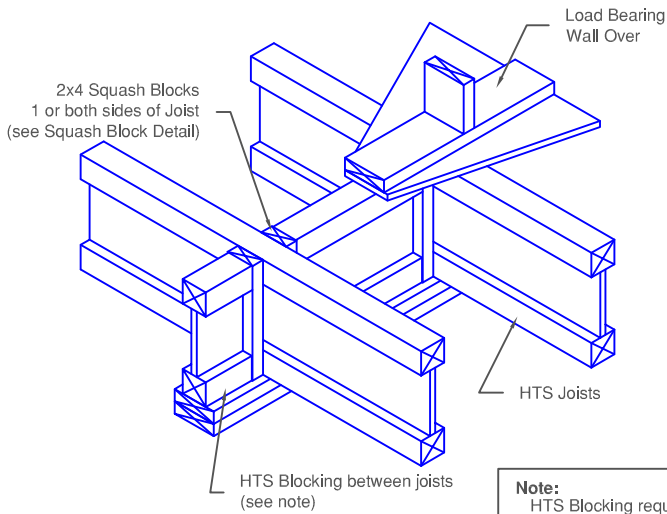

Note:
HTS Blocking required for a min. of 3 spaces at each end and 20' o/c for length of bearing wall

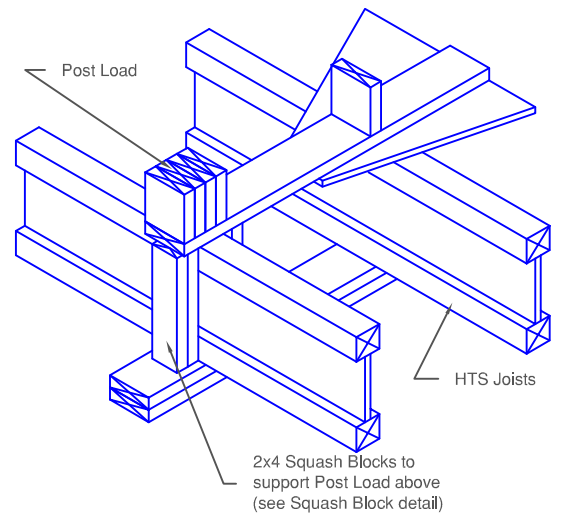

D1 Interior Load Bearing Wall

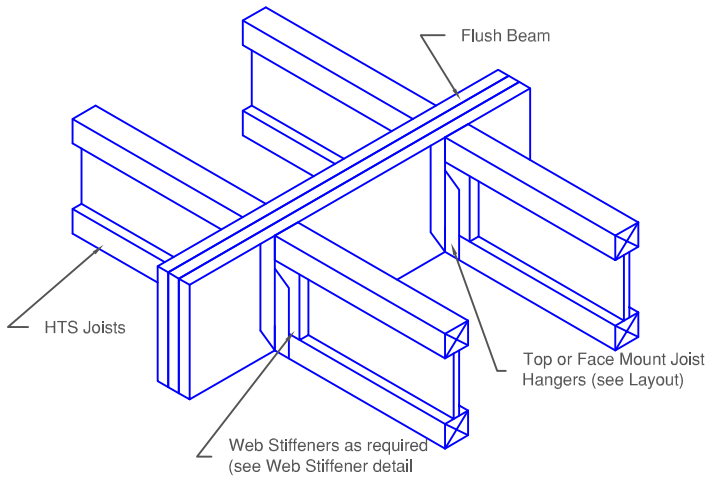

D2 Interior Post Load

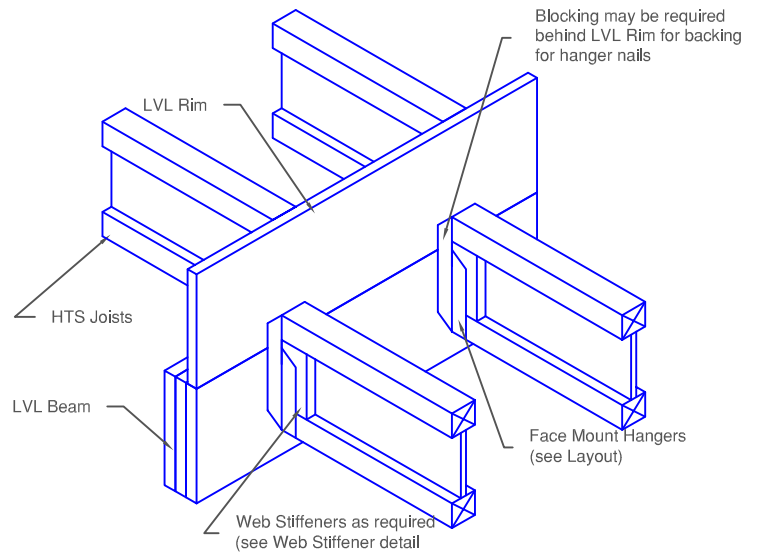

E1 Interior Bearing

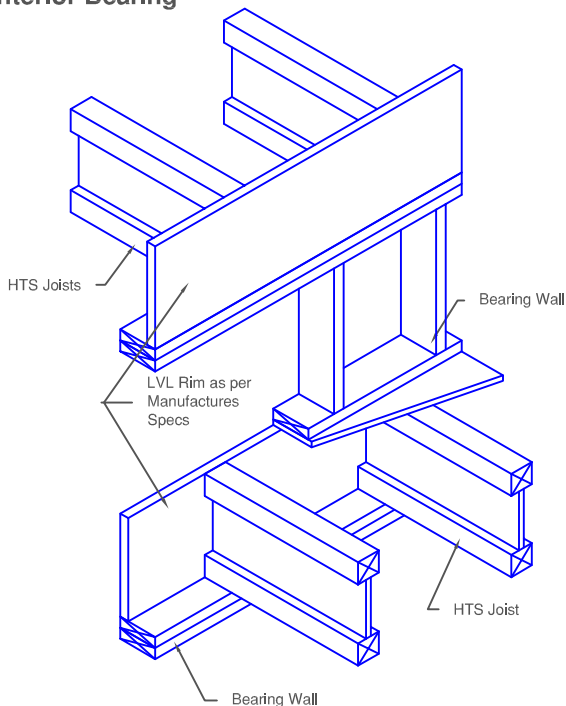

E2 Dropped Floor

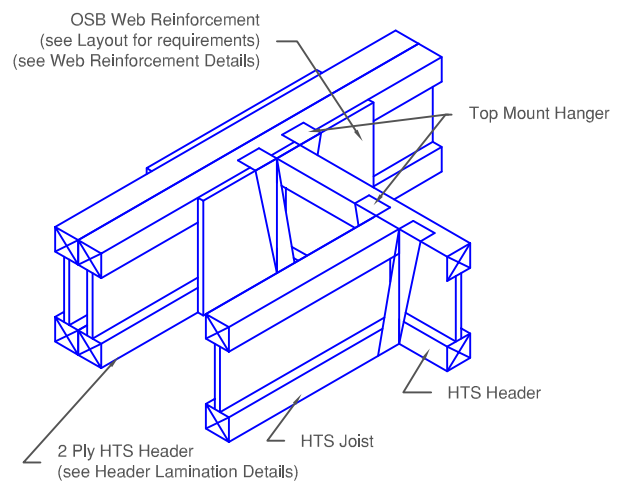

E3 Split Level Bearing

H1 Header

HTS Floor - Misc. Details

Squash Blocks are used to transfer Uniform or Concentrated Loads thru the floor system as per the following details and tables.

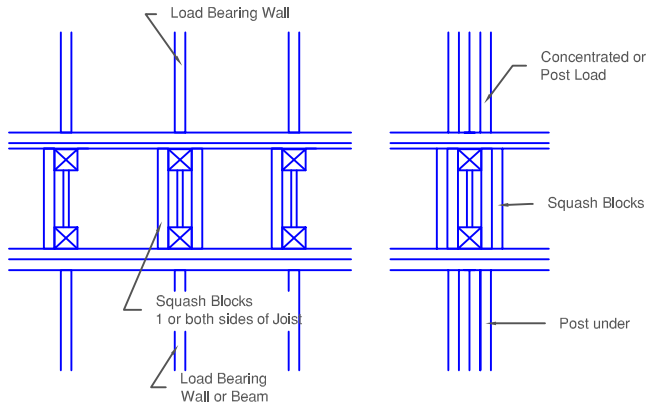

Uniform Load

Concentrated Load

Factored Loading Values							
Uniform Loading							
Size	Spacing						
	12" o/c		16" o/c		19.2" o/c		24" o/c
2x3	2305	4610	1730	3460	1440	2880	2300
2x4	3230	6460	2420	4840	2015	4030	3230
2x6	5070	10140	3805	7610	3170	6340	5070
Concentrated Load							
Size	Number of Squash Blocks						
	1	2	3	4			
2x3	2305	4610	6915	9220			
2x4	3230	6460	9690	12920			
2x6	5070	10140	15210	20280			

Notes:

1. Squash Blocks to be cut 1/16" longer the depth of HTS Joists.
2. The end area of the Squash Block to be in full contact with bearing plate.
3. Values based on SPF with a bearing capacity of 769 psi.

Squash Blocks

Web Reinforcement is used to reinforce the web of a HTS Joist as required for increased bearing capacity, locations of concentrated loads or hangers or large hole locations.

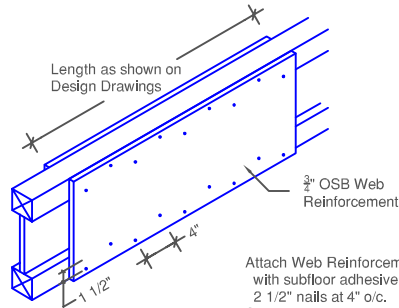

Attach Web Reinforcement to flanges with subfloor adhesive and nail with 2 1/2" nails at 4" o/c. Stagger nails as shown for HTS34 or HTS36 series Joists.

Web Reinforcement

Web Stiffeners required for face mount hangers where hanger does not support top flange of HTS Joist

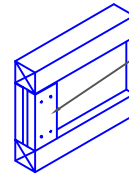

1 1/4" x 3 1/2" Dimensional Lumber or LVL web stiffeners
Attach with 4 - 3 1/4" nails - 2 each side

Web Stiffeners